

# Montpellier

THE PERFECT BALANCE OF FUNCTION AND STYLE

LAUNDRY - DISHWASHING - COOKING - COOLING

## Installation and Operating Instructions



### Freestanding Washing Machine

MW7145 - MW8145 - MW9145 - 1400rpm

Please read these instructions carefully before attempting to install or use this appliance.  
We recommend that you keep these instructions in a safe place for future reference.

# Welcome

---

Thank you for choosing this Montpellier Washing Machine

Our Washing Machines have been designed to provide you with the best combination of style, reliability and performance to give you years of trouble-free use.

You may be familiar with a similar product, but please take time to read these instructions carefully before installing or using your Washing Machine to ensure you get the most from your purchase.

We recommend that you keep this manual in a safe place for future reference.

Your Washing Machine is covered by a comprehensive two year Parts & Labour Guarantee. In the unlikely event that you experience a problem with your Washer, you can rest assured that you are fully protected against the cost of repairs for the first 24 months. Please note that any claim must be accompanied by the model reference number, serial number and proof of purchase.

To activate your guarantee, you will need your product serial number. This can be found **inside the door of your washing machine**

There are two ways to register your Guarantee:

- **Online:** Visit the Support page on our website and complete the online Product Registration form. [www.montpellier-appliances.com](http://www.montpellier-appliances.com)
- **By Post:** Simply detach and fill in the form provided, attach a stamp and send it in the post. Don't forget to include your e-mail address so that we can send confirmation through to you.



**Note:** We are unable to take registrations over the phone.

---

**2**  
**YEAR**  
**GUARANTEE**  
— PARTS & LABOUR —  
ACROSS ALL OUR MODELS  
**Montpellier**  
www.montpellier-appliances.com

# CONTENTS

---

## SAFETY INSTRUCTIONS

- Safety Instructions..... 2

## INSTALLATION

- Product Description..... 7
- Installation..... 8

## OPERATIONS

- Quick Start ..... 11
- Before Each Wash..... 12
- Detergent Dispenser..... 13
- Control Panel..... 14
- Programme Options..... 15
- Function Options..... 16
- Programme Guide..... 18
- Programme Matrix..... 19
- Wash Load Table..... 20

## MAINTENANCE

- Cleaning And Care ..... 21
- Trouble Shooting ..... 24
- Technical Specifications ..... 25
- Product Fiches ..... 26

# SAFETY INSTRUCTIONS

---

## ■ Safety Instructions

For your safety, the information in this manual must be followed to minimize the risk of fire or explosion, electric shock, or to prevent property damage, personal injury or loss of life.

Explanation of the symbols:

### Warning!

This combination of symbol and signal word indicates a potentially dangerous situation which may result in death or serious injuries unless it's avoided.

### Caution!

This combination of symbol and signal word indicates a potentially dangerous situation which may result in slight or minor injuries or damage to property and the environment.

### Note!

This combination of symbol and signal word indicates a potentially dangerous situation which may result in slight or minor injuries.

### Warning!

Electric shock!

- If the supply cord is damaged, it must be replaced by the manufacturer, its service agent or similarly qualified person in order to avoid a hazard.



# SAFETY INSTRUCTIONS

---

- The new hose supplied with the appliance is to be used and the old hose/s should be discarded
- Before carrying out any maintenance please ensure that the appliance is unplugged from the mains supply.
- Always unplug the appliance and turn off the water supply after use and especially if the appliance is not to be used for a prolonged period of time.
- To ensure your safety the mains plug must be plugged in to a suitable 13amp switched wall socket which is properly and reliably earthed. If you notice any discolouring or damage to the wall socket this must be replaced by a qualified person straight away.
- Make sure that the appliance is connected by a suitably qualified technician in accordance with the manufacturers instructions and local safety regulations.

## **Risk to children!**

- EN countries: the appliance can be used by children aged from 8 years and above and persons with reduced physical, sensory or mental capabilities or lack of experience and knowledge if they have been given supervision or instruction concerning use of the appliance in a safe way and understand the hazards involved. Children shall not play with the appliance. Cleaning and user maintenance shall not be made by children without supervision.
- Children of less than 3years should be supervised to ensure that they do not play with appliance.
- Animals and children may climb into the machine. Check the machine before every operation.

# SAFETY INSTRUCTIONS

---

- The glass door may become very hot during operation. Keep children and pets away from the appliance during use.
- Remove all packaging and transit bolts before using the appliance. Failure to do so could result in serious damage and invalidate your guarantee. Transport bolts should be retained in case of the appliance being moved in the future.
- Plug must be accessible after installation.

## Risk of explosion!

- Do not wash or dry articles that have been cleaned in, soaked in, or dabbed with combustible or explosive substances (such as wax, oil, paint, gasoline, degreasers, dry-cleaning solvents, kerosene, etc.) This may result in fire, explosion or contamination of your appliance. Before washing any items in the washing machine that may have come in to contact with such substances make sure they have been thoroughly rinsed by hand.

## ⚠ Caution!

## Installing the product!

- This washing machine is designed for indoor use only.
- It is not intended to be built-in to a housing.
- Do not install on a surface (such as carpet) that would prevent ventilation at the base of the appliance.
- The washing machine shall not be installed in a bathroom, wet room or any rooms where moisture, explosive or caustic gases could be present.
- Washing machines fitted with a single cold inlet valve should be connected to the cold supply only.
- Plug must be accessible after installation

# SAFETY INSTRUCTIONS

---

## Risk of damaging the appliance !

- Remove all packaging and transit bolts before using the appliance otherwise serious damage may result !
- This washing machine is only for domestic use and is only designed for the textiles suitable for a domestic washing machine.
- Do not climb or sit on the appliance at all.
- Do not lean against or use excessive force on the door
- Cautions during handling of the machine:
  1. Transport bolts shall be carefully reinstalled to the appliance by a suitably qualified person.
  2. Any residual water left in the appliance shall be drained out of the appliance.
  3. The appliance should always be handled with care. Do not carry, lift or move the appliance with any part protruding from the appliance. The door should never be used as a handle when moving the appliance.
  4. This appliance is very heavy. Always transport with care and we strongly recommend that it is moved by a minimum of two people.
- It is forbidden to wash carpets.

## Operating the appliance!

- Before using for the first time it is recommended to run the washer through one complete wash cycle at a minimum temperature of 40° without any clothes and use half of your usual amount of detergent.
- Flammable, Explosive or Toxic solvents are forbidden. Gasoline and alcohol etc should not be used as detergents or cleaning agents in any way. Please only use the correct detergents suitable for a domestic automatic washing machine.

# SAFETY INSTRUCTIONS

---

- Make sure that all pockets are checked and emptied. Sharp or rigid items such as coins, jewellery, nails and screws etc may cause serious damage to the appliance and clothing. This will also not be covered under your guarantee.
- Please check whether the water inside the drum has drained away before attempting to open the door. Please do not open or try to force the door open if any water is visible.
- Do not touch the drain hose or any discharged water during operation of the appliance as the high temperatures could pose a burn risk.
- Never refill with water by hand during the washing cycle.
- After the programme has finished please wait for two minutes before opening the door.

## Packaging/Old appliance



This marking indicates that this product should not be disposed with other household wastes throughout the EU. To prevent possible harm to the environment or human health from uncontrolled waste disposal, recycle it responsibly to promote the sustainable reuse of material resources. To return your used device, please use the collection systems or contact the retailer where the product was purchased.

They return and can take this product for environmental safe recycling.

# INSTALLATION

## ■ Product Description

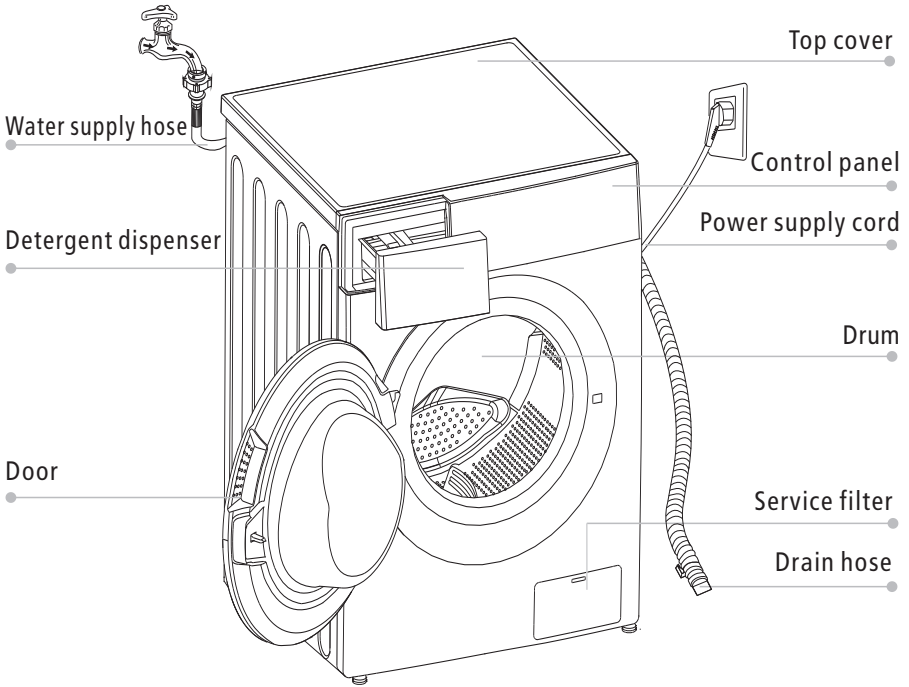

### Note!

- The product line chart is for reference only, please refer to real product as standard.

## Accessories

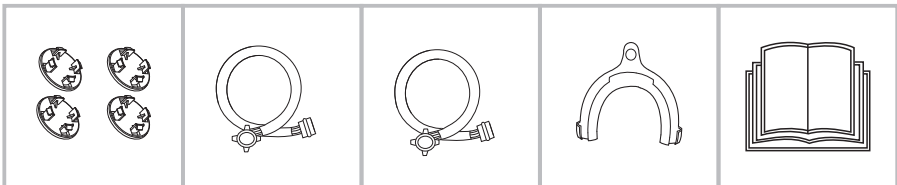

Transport hole plug

Supply hose cold water

Supply hose hot water (optional)

Drain hose support (optional)

Owner's manual

# INSTALLATION

## ■ Installation

### ⚠ Warning!

- Stability is extremely important for quiet and vibration free running.
- Make sure the appliance doesn't stand on the mains cable.

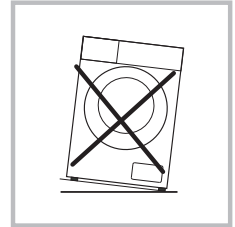

Before installing the appliance ensure that all below points are adhered to:

1. Install on a dry, rigid and level surface.
2. Avoid direct sunlight.
3. Make sure the appliance has sufficient ventilation.
4. Room temperature is above 0°C
5. Keep far away from the heat resources such as heating pipes/radiators

### Unpacking the washing machine

### ⚠ Warning!

- Packaging material (e.g. Films, Styrofoam) can be dangerous for children.
- There is a risk of suffocation ! Keep all packaging well away from children.

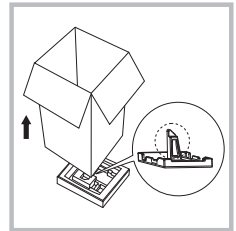

1. Remove the cardboard box and styrofoam packing.
2. Lift the washing machine and remove the base packing. Make sure the small triangle foam is removed with the bottom one together. If not, lay the unit down with side surface, then remove the small foam from the unit bottom manually.
3. Remove the tape securing the power supply cord and drain hose.
4. Remove the inlet hose from the drum.

### Remove transport bolts

### ⚠ Warning!

- You must remove the transport bolts from the backside before using the product.
- You'll need the transport bolts again if you move the product, so make sure you keep them in a safe place.

Please take the following steps to remove the bolts:

1. Loosen 4 bolts with spanner and then remove them.
2. Stop the holes with transport hole plugs.
3. Keep the transport bolts properly for future use.

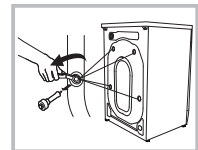

# INSTALLATION

## Levelling the washing machine

### ⚠ Warning!

- The lock nuts on all four feet must be screwed tightly against the housing.

1. Check if the legs are closely attached to the cabinet. If not, please turn them to their original positions tighten the nuts.
2. Loosen the lock nut turn the feet until it closely contacts with the floor.
3. Adjust the legs and lock them with a spanner, make sure the machine is steady.

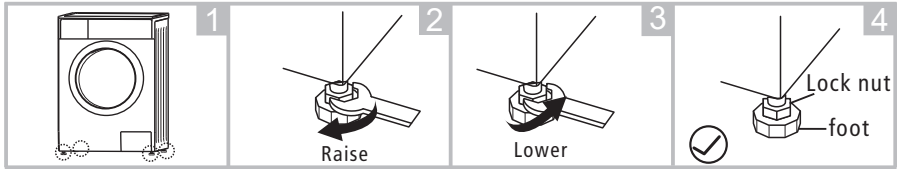

## Connect Water Supply Hose

### ⚠ Warning!

- To prevent leakage or water damage, follow the instructions in this chapter!
- Do not kink, crush, modify or sever water inlet hose.
- For models fitted with a hot water inlet valve connect to a hot water supply with a suitable hot water supply hose.

Connect the inlet pipe as indicated, There are two ways to connect the inlet pipe.

1. Connection between ordinary tap and inlet hose.

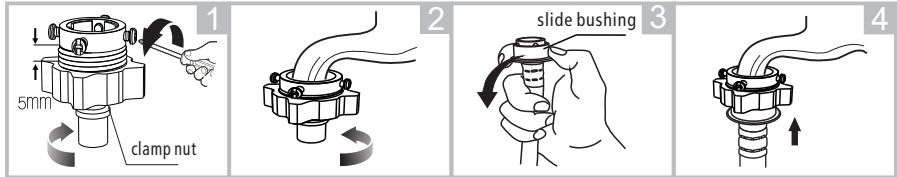

Loosen clamp nut and four bolts

Tighten clamp nut

Press slide bushing, insert inlet hose into connecting base

Connection finished

2. Connection between screw tap and inlet hose. (Standard UK fitting)

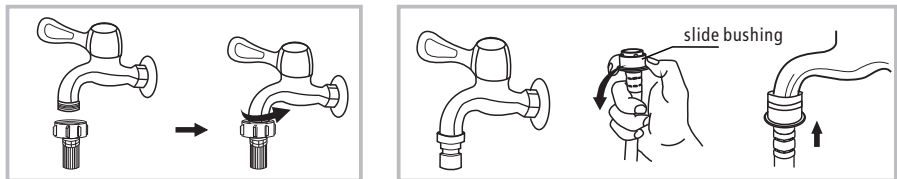

Tap with threads and inlet hose

Special tap for washing machine

# INSTALLATION

Connect the angled end of the cold water inlet hose to the cold water inlet valve at the rear of the appliance and tighten securely in a clockwise motion.

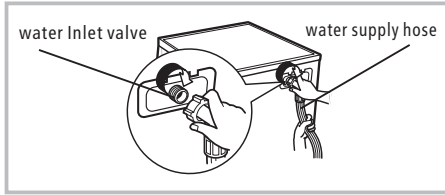

## Drain Hose

### ⚠ Warning!

- Do not kink or extend the drain hose
- Position the drain hose correctly to avoid damage which may result in a leak

There are two ways to connect the drain pipe to a water outlet.

1. Connect the drain to a suitable stand pipe or
2. connect to an outlet below a household sink.....see below.

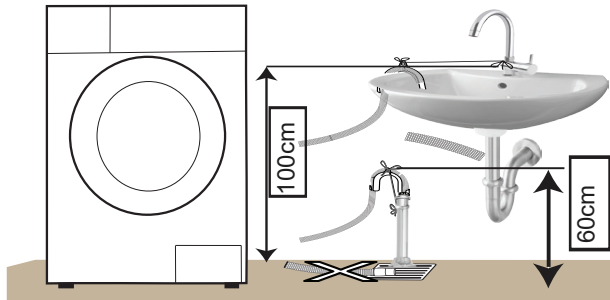

### 📌 Note!

- If the machine has drain hose support, please install it like the following .

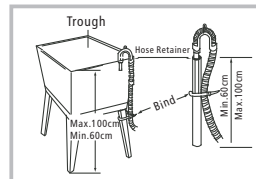
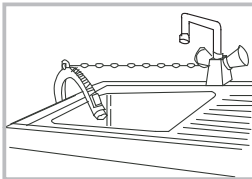

### ! Warning!

When the drain hose has been installed check that it is secure and will not move or become dislodged during discharge of the drain water  
If the drain hose is too long do not force it back in to the washing machine as this will cause damage to the hose/appliance



# OPERATIONS

## ■ Quick Start

### ⚠ Caution!

- Before using the appliance make sure that it is correctly installed.
- Before washing for the first time it is advisable to run the appliance through one complete wash cycle at a minimum temperature of 40°C without any clothes and using half your usual amount of detergent.

## 1. Before Washing

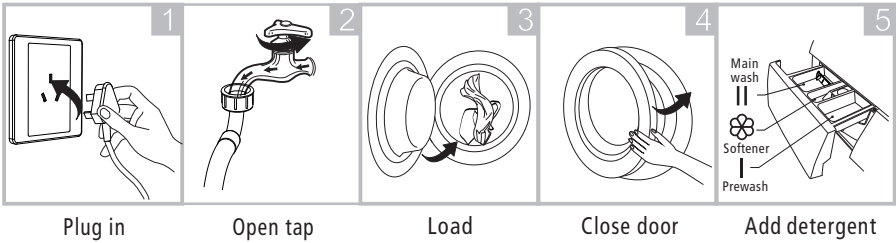

### 📌 Note!

- If selecting the pre-wash option a small amount of detergent may be added to compartment I (see diagram 5)

## 2. Washing

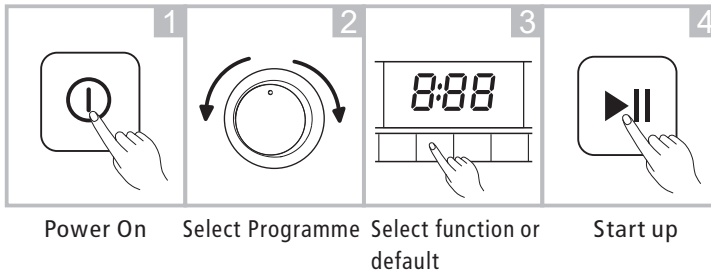

# OPERATIONS

## Note!

- 1.If default is selected, step 3 can be skipped.
- 2.The function button line chart is for reference only, please refer to real product as standard.

## 3. After Washing

Buzzer beep or "End" on display.

### ■ Before Each Wash

- The necessary ambient temperature for operation of your washing machine is between 5-40° C. If used below 0°C the inlet valve and draining system may be damaged as well as the possibility of split hoses. If the ambient temperature is below 0°C then the appliance would need to be moved to somewhere with a higher temperature to ensure the water supply and drain hoses are not frozen before using.
- Please check laundry care labels and the correct dosing instructions on your detergent before use. Only use detergent suitable for a domestic washing machine.

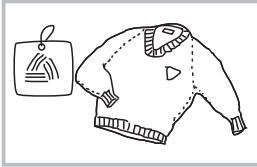

Check the label

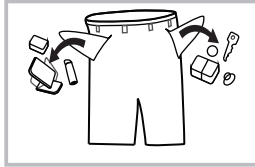

Remove all items from pockets.

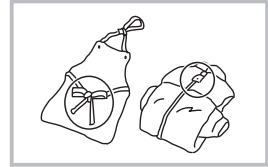

Securely fasten all long ties, zips or buttons

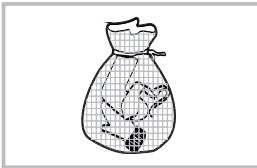

Put small items securely in a pillow case or laundry bag.

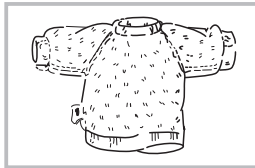

Turn easy-pilling and long-pile fabric inside out

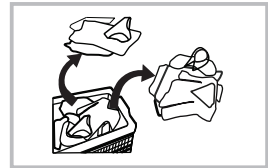

Separate different fabric types and colours

## ⚠ Warning!

- When washing single items or very small loads this may cause an out-of balance load which may result in poor spin results or an error, If this happens it is suggested that you add one or two more items to even out the load.
- Don't wash clothes that have come in to contact with gasoline, alcohol and other flammable materials.

# OPERATIONS

## ■ Detergent Dispenser

- I Pre wash detergent
- II Main wash detergent
- ☼ Softener

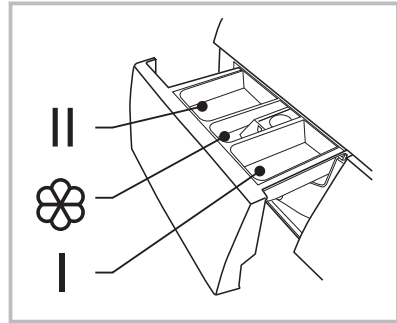

Pull out the dispenser

### ⚠ Caution!

- Detergent should only be added to the Pre-wash compartment if pre-wash has been selected as an option

Programme	I	II	☼	Programme	I	II	☼
Sterilization		●	○	Self Clean		●	○
Cotton	○	●	○	Spin Only			
20°C		●	○	Rinse & Spin			○
Mix	○	●	○	Baby Care	○	●	○
Wool		●	○	Sport	○	●	○
Synthetic	○	●	○	Duvet	○	●	○
Eco 40-60		●	○	Rapid 45'	○	●	○
Intensive		●	○	Quick 15'		●	○

● Means required

○ Means optional

### 📌 Note!

- Thick or concentrated softeners may cause clogging of the soap drawer inlets so it is advisable to dilute if possible, also excessive use of powder may also cause clogging. Always use detergents produced for automatic washing machines and follow the dosing guidelines from the detergent manufacturer.
- Please choose the correct type of washing detergent for required temperatures and clothing to achieve the best performance with less water and energy consumption.

# OPERATIONS

## Control Panel

Model: MW7145 - MW8145 - MW9145

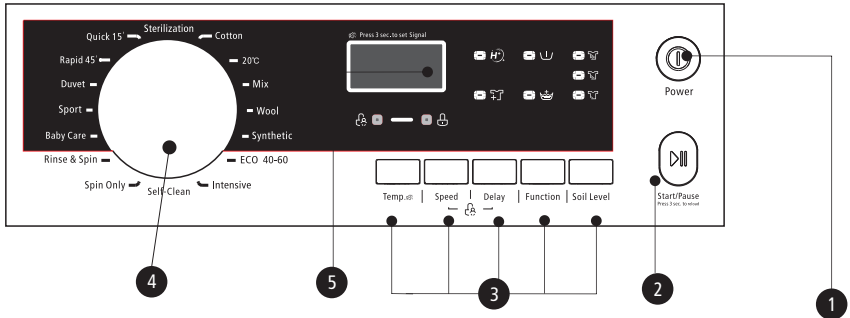

### Note!

- The chart is for reference only, Please refer to your machine panel for info.

#### 1 Power

Product is on/off.

#### 2 Start/Pause

Press the button to start or pause the washing cycle.

#### 3 Option

This allows you to select an additional function and will light when selected.

#### 4 Programmes

Available according to the laundry type.

#### 5 Display

The display shows the settings, estimated time remaining, options, and status messages for your washer. The display will remain on through the cycle.

A	Display
Wash Time	Delay Time
1:25	2h
Speed	Error
100	E30
End	Temp.
End	30

- B** Child Lock
- C** Hygiene Pro
- D** Stop Add Go
- E** Door Lock
- F** Pre Wash
- G** Extra Rinse
- H** Soil Level

# OPERATIONS

## ■ Programme Options

Temp.

3

Press the Temp button to change the required wash temperature if a temperature other than the default is required (Cold,20,30,40,60,90)

Speed

3

Press the speed button to change the required speed if a spin speed other than the default is required (0,400,600,800,1000,1200,1400)

Programme	Default Speed(rpm)	Programme	Default Speed(rpm)
	1400		1400
Sterilization	800	Self Clean	–
Cotton	1400	Spin Only	1000
20°C	1000	Rinse & Spin	1000
Mix	800	Baby Care	800
Wool	600	Sport	800
Synthetic	1200	Duvet	1000
Eco 40-60	1400	Rapid 45'	800
Intensive	800	Quick 15'	800

Delay

3

To set the delay function :

1. Select a programme; 2. Press the Delay button to choose the time(the delaying time is 0-24 H.);
3. Press [Start/Pause] to commence the delay operation



Choose the Programme

Setting time

Start

Canceling the delay function:

Press the (Delay) button until the display shows 0H. This should be done before starting the programme. If the programme has already been set then switch off the appliance and restart a new programme.



# OPERATIONS



## Function Options

**Function** **3** Use the function button to select the required functions available with each wash cycle - refer to the programme guide for the options available.

**B**



Choose the Programme      Start      Press [Speed] and [Delay] 3 sec. till buzzer beep.

**! Caution!**

- V[ Á^æçæ Á@ÁçÁí & Á!^• Áç áÁç |áÁ@ÁÚ] ^ááBÁÖ\æ Áá~ çí } • Áí !ÁÁ^&í } á•
- V@ÁÖ çáÁí & Áç ç|Áí & Áç|Á~ çí } • Á çsepó@ÁÚ[ , ^!Á~ çí } É
- QÁ@Áç^ ) çí -Á@Á[ , ^!Á~ ] ] | Á^ç \* Á~ çí -Áí Á@Á æçç ^Á@ÁÖ çáÁí çk { æ Á[ çá á^Áæçç^Áí } & Á@Á[ , ^!Á~ ] ] | Á^Á ççæ á

**H+** **C**

**Hygiene Pro**

If selected the self-clean function will be automatically activated during every wash cycle.

Hygeine Pro system keeps the laundry always clean, saves time and limits environmental impact.



 Press for 3 seconds > Add Clothing >  Press To Go !

Start/Pause P113 3.0C.101044      Start/Pause P113 3.0C.101044

**STOP ADD GO**

When you've forgotten to add an item of clothing to your wash, our handy "Stop Add Go" technology allows you to stop the cycle to open the door and add the item and go. For safety reasons if the temperature inside the drum exceeds 40°C or the water level is to high this feature will not be available and give a series of audible beeps to indicate this is an invalid operation.

# OPERATIONS

---

## ■ Function Options



### Pre Wash

The Pre-wash function allows you to give heavily soiled items a pre-wash before the main washing programme takes place. When using this function put detergent in compartment I of the soap drawer.

---



### Extra Rinse

The laundry will undergo an extra rinse once this option is selected.

---



### Soil Level

Select the required soil level according to the degree of soiling of the clothes, the programme will automatically control the washing time and rhythm of the wash.

---



### Door Lock

This will indicate when the cycle starts and the door is locked.

---



### Muting the Buzzer



Choose the Programme



Press and hold the [Temp] button for 3 seconds to mute the buzzer.

To reactivate the buzzer repeat the same process as above for 3 seconds.

---

## ⚠ Caution!

- Once you have muted the buzzer it will not sound again until you reactivate it.

# OPERATIONS

## ■ Programme Guide

Please refer to your wash care label in all garments and choose the suitable programme from the list below

Programmes	
Cotton	Designed for hard wearing textiles, cotton garments or clothes that require a high agitation wash such as towels and sheets.
Synthetic	Medium agitation wash designed for synthetic fabrics such as nylon, polyester and acrylic blended items
Baby Care	Intensive wash cycle designed to help remove heavy stains as well as bacteria and allergens using a higher temperature, followed by several rinses to make sure as much detergent is removed from the garments to protect delicate skin.
Rapid 45'	Quick wash cycle for up to 2kg of lightly soiled garments
Mix	Ideal for a load with mixed fabrics such as cotton and synthetics.
20°C	A cold wash using either cold water only or a temperature of 20°C
Sterilization	This cycle maintains a 70°C temperature for 30 minutes during the cycle to help sterilize your clothes as well as the appliance
Quick 15'	Extra quick cycle for those small or single lightly soiled items you need in a hurry
ECO 40-60	ECO cycle suitable for fabrics designed to be washed between 40°C-60°C. Temperature is set at 40°C
Wool	Low temperature wash designed for machine washable wool, wool rich textiles and delicate clothes. Especially gentle wash action and laundry pauses for longer in the water to avoid damage and shrinkage.
Spin Only	Extra spin with selectable spin speed
Rinse&Spin	Extra rinse and spin with selectable spin speed
Intensive	Increased washing time/action to give better results
Self Clean	Special programme designed to clean the drum and pipework. It will do a set 90°C wash cycle to help eliminate bacteria and a build up of dirt inside the machine. You should <b>not</b> put any clothes or garments in the appliance during this cycle. For best results it is advisable to use a powder detergent.
Sport	Specially designed programme for washing active sportswear.
Duvet	Specially designed programme for washing Duvets



# Programme Matrix

Cycle	Delay	Spin	Function	Soil Level
Sterilization	<b>2:27 (70°C)</b>	Cold, 20, 30, 40, 60, 90 <b>70</b>	1400rpm 0/400/600/800/1000/1200/1400 0/400/600/800/1000/1200/1400	-- -- O
Cotton	<b>3:39 (40°C)</b>	Cold, 20, 30, <b>40</b> , 60, 90	0/400/600/800/1000/1200/1400	-- O
20°C	<b>1:11 (20°C)</b>	Cold, <b>20</b> ,	0/400/600/800/1000/1200	O -
Mix	<b>1:30 (40°C)</b>	Cold, 20, 30, <b>40</b> , 60, 90	0/400/600/800/1000/1200/1400	O O
Wool	<b>1:07 (40°C)</b>	Cold, 20, 30, <b>40</b>	0/400/600/ 800	-- O
Synthetic	<b>3:28 (40°C)</b>	Cold, 20, 30, <b>40</b> , 60	0/400/600/800/1000/1200	O O
Eco 40-60	<b>3:13</b>	-	<b>1400</b>	-- -
Intensive	<b>3:48 (40°C)</b>	O <b>40</b> , 60	0/400/600/800/1000/1200/1400	-- --
Self-Clean	<b>1:18 (90°C)</b>	O <b>90</b>	-	-- --
Spin Only	<b>0:12</b>	O --	0/400/600/800/1000/1200/1400	-- --
Rinse & Spin	<b>0:30</b>	O --	0/400/600/800/1000/1200/1400	O O
Baby Care	<b>1:53 (60°C)</b>	O Cold, 20, 30, 40, <b>60</b> , 90	0/400/600/800/1000/1200	O O
Sport	<b>1:16 (40°C)</b>	O Cold, 20, 30, <b>40</b>	0/400/600/800/1000/1200/1400	O O
Duvet	<b>1:48 (40°C)</b>	O Cold, 20, 30, <b>40</b> , 60	0/400/600/800/1000/1200/1400	O O
Rapid 45'	<b>0:45 (40°C)</b>	O Cold, 20, 30, <b>40</b> , 60	0/400/600/800/1000/1200/1400	-- O
Quick 15'	<b>0:15 (Cold)</b>	O <b>Cold</b> , 20, 30	0/400/600/800	-- --

O Means selectable option      **90** **1400** **Med** Numbers/words in **Bold** represent the default value

Times stated are for reference only as they will vary depending on load and ambient temperatures

# OPERATIONS

## ■ Wash Loading Table

Model: MW7145 - MW8145 - MW9145



### Note!

Please refer to the below chart for the loading guidelines of your specific model according to the programme selected

Programme	Load(kg)			Programme	Load(kg)		
	7.0	8.0	9.0	Default	7.0	8.0	9.0
Sterilization	5.0	5.0	5.0	Self Clean	–	–	–
Cotton	7.0	8.0	9.0	Spin Only	7.0	8.0	9.0
20°C	3.5	4.0	4.5	Rinse & Spin	7.0	8.0	9.0
Mix	7.0	8.0	9.0	Baby Care	7.0	8.0	9.0
Wool	2.0	2.0	2.0	Sport	3.5	4.0	4.5
Synthetic	3.5	4.0	4.5	Duvet	3.5	4.0	4.5
Eco 40-60	7.0	8.0	9.0	Rapid 45'	2.0	2.0	2.0
Intensive	7.0	8.0	9.0	Quick 15'	2.0	2.0	2.0

- Concerning to Regulation(EU) No 1061/2010,The EU energy efficiency class is: A+++; Energy test program: Intensive 60/40 °C; Speed:The highest speed;Other as the default. Half load for 7.0/8.0/9.0Kg machine:3.5/4.0/4.5Kg.
- Concerning to Regulation(EU) 2019/2023,The EU energy efficiency class is: B; Energy test program: ECO 40-60. Other as the default. Half load for 7.0/8.0/9.0Kg machine:3.5/4.0/4.5Kg. Quarter load for 7.0/8.0/9.0Kg machine:2.0/2.0/2.5Kg.

# MAINTENANCE

---

## ■ Cleaning And Care

### Warning!

- Before starting any maintenance tasks on your appliance, please unplug and make sure the water supply is turned off

### Cleaning The Cabinet

Proper maintenance of the washing machine can extend its working life. All surfaces can be cleaned with diluted non-abrasive neutral detergents where necessary. If there is excessive water make sure this is wiped up immediately. Do not use any sharp items when cleaning the appliance

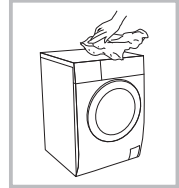

### Note!

- Formic acid and diluted solvents or equivalent such as alcohol, solvents or chemical products etc. are forbidden when it comes to cleaning the appliance.

### Cleaning The Drum

Any rust deposits left inside the drum from metal articles washed in the appliance should be removed immediately with chlorine-free detergents. Never use wire wool !

### Note!

- Don't put laundry in the washing machine while cleaning the drum

### Cleaning the Door Glass and Seal

Wipe the glass and seal after each use to remove lint and stains. If lint is allowed to build up this can cause leaks. Remove any coins or objects from the door seal after each wash. It is advisable to then leave the door slightly open after use to allow air to circulate and avoid the build up of bacteria.

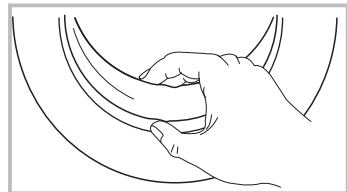

# MAINTENANCES

## Cleaning The Inlet Filter

### Note!

- Inlet filter must be checked and cleaned if there is a drop in the inlet pressure

Washing the inlet hose filter :

1. Close the tap.
2. Remove the water supply hose from the tap.
3. Clean the filter.
4. Reconnect the water supply hose.

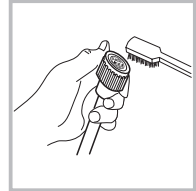
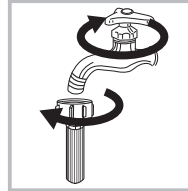

Washing the inlet valve filter :

1. Screw off the inlet pipe from the backside of the machine.
2. Pull out the filter with long nose pliers and reinstall it back after being washed.
3. Use the brush to clean the filter.
4. Reconnect the inlet pipe.

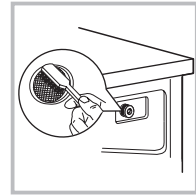
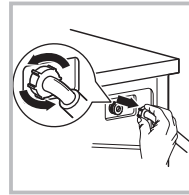

## Clean The Detergent Dispenser

1. Press down the arrow located on the softener cover inside the dispenser drawer and fully slide out the drawer.
2. Lift the clip and remove the softener cover, wash all compartments thoroughly with water
3. Thoroughly clean the top of the soap dispenser with an old tooth brush or suitable bottle brush, DO NOT wipe with a cloth !!
4. Replace the softener cover and push the drawer back into position.

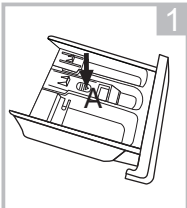

Pull out the drawer after depressing **A**

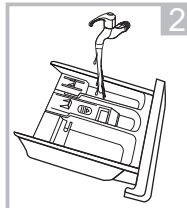

Clean the drawer under water

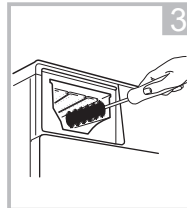

Clean inside the dispenser with a brush

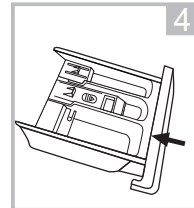

Insert the dispenser drawer

### Note!

- Do not use alcohol, solvents or chemical products to clean the machine.

# MAINTENANCES

## Cleaning The Drain Pump Filter

### ⚠ Warning!

- Be careful as the water left in the appliance may be very hot !!
- Allow water to cool before attempting to drain the washer or cleaning the filter.
- Unplug the appliance to avoid any risk of electric shock while removing the filter

1. The drain pump filter is located behind the cover on the front-lower right corner of the washing machine.

Before attempting to remove the filter place a container and a towel on the floor to collect the water left in the machine.

2. Loosen the filter by turning anticlockwise and wait for the water to fully drain before removing the filter fully, dependent on the amount of water inside the washer you may need to tighten the filter and repeat the process a few times until all the water has drained

3. Clean the filter and remove any foreign objects from inside the filter housing

4. After cleaning replace the filter and tighten clockwise ensuring it is fully tightened and the cover closed.

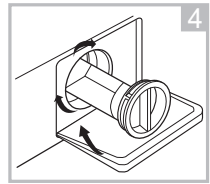
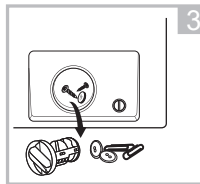
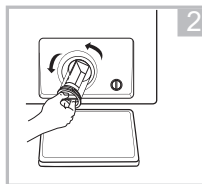
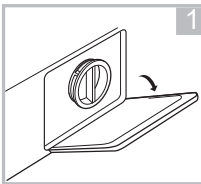

### ⚠ Caution!

- When the appliance is in use and depending on the programme selected there can be hot water in the pump. Never remove the pump cover during a wash cycle, always wait until the appliance has finished the cycle, and is empty. When replacing the cover, ensure it is securely re-tightened.
- Make sure that before using for the first time after removing the filter you check and make sure there are no leaks.

# MAINTENANCES

## ■ Troubleshooting

If your appliance does not start or it stops during operation, first try and find a solution below, if not contact the service centre.

Description	Reason	Solution
Washing machine doesn't start up	Door is not closed properly	Check the door is closed and no garments are stopping it from closing
Door can't be opened	Washer's safety protection design is working	Disconnect the power, restart the appliance
Water leakage	The connection between inlet or outlet hose is not tight	Check and secure inlet and outlet hoses
Detergent residues in the drawer	Detergent is dampened or agglomerated	Clean and wipe the detergent drawer, check inlet hose filter
Indicator or display does not light	Disconnect the power, PC board or harness has connection problems	Check the power is turned on, check fuse is ok.
Abnormal noise		Check the transit bolts have been removed, Check it's installed on a solid and level floor, Check for foreign objects in the drum or pump

## Fault Codes

Description	Reason	Solution
<b>E30</b>	Door is not closed properly	Restart after the door is closed Check if any clothes are stuck
<b>E10</b>	Water intake problem while washing	Check if the water pressure is too low Straighten the water pipe Check if the inlet filters are blocked
<b>E21</b>	Overtime water draining	Check if the drain hose or drain pump are blocked
<b>E12</b>	Water overflow	Restart the washer and try again
<b>EXX</b>	Others	Please try again first, call up service line if there are still troubles

### Note!

- After all checks, try the appliance again. if the problem or error code persists contact the service department.

# MAINTENANCES

## ■ Technical Specifications

Power Supply 220-240V~,50Hz(EU/IR)

MAX.Current 10A

Standard Water Pressure 0.05MPa~1MPa

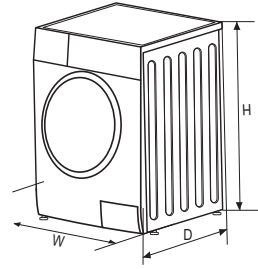

Model	Washing Capacity	Dimension (W*D*Hmm)	Net Weight	Rated Power
MW7145W	7.0kg	595*495*850	61kg	2000W
MW8145W	8.0kg	595*565*850	68kg	2000W
MW9145W	9.0kg	595*565*850	71kg	2000W

# MAINTENANCES

Product fiche concerning to EN 60456:2016 With (EU)No.1061/2010.

Trade mark	
Model identifier	MW7145W
Rated capacity in kg of cotton laundry	7
Energy efficiency class on a scale from A+++ (most efficient) to D (least efficient )	A+++
Energy consumption <b>155</b> kWh per year, based on 220 standard washing cycles for the standard cotton programmes at 60 °C and 40 °C at full and partial load, and the consumption of the low-power modes.Actual energy consumption will depend on how the appliance is used.	
Energy consumption of the standard 60°C cotton programme at full load	0.75kwh
Energy consumption of the standard 60°C cotton programme at partial load	0.70kwh
Energy consumption of the standard 40°C cotton programme at partial load	0.57kwh
Weighted power consumption of the off-mode	0.50W
Weighted power consumption of the left-on mode	1.00W
Water consumption 9900 litres per year, based on 220 standard washing cycles for the standard cotton programmes at 60 °C and 40 °C at full and partial load. Actual water consumption will depend on how the appliance is used.	
spin-drying efficiency class B on a scale from G (least efficient) to A (most efficient)	
maximum spin speed - RPM	1400
Remaining moisture content	53%
'Intensive 60°C programme' and the ' Intensive 40°C programme' are the standard washing programmes to which the information in the label and the fiche relates, that these programmes are suitable to clean normally soiled cotton laundry and that they are the most efficient programmes in terms of combined energy and water consumption.	
Programme time of the standard 60°C cotton programme at full load	280min
Programme time of the standard 60°C cotton programme at half load	270min
Programme time of the standard 40°C cotton programme at half load	270min
duration time of left-on mode	1min
Airborne acoustical noise emissions during washing phase	57dB
Airborne acoustical noise emissions during spinning phase	79dB
'built-in' washing machine	no

Energy test program: Intensive 60/40 °C; Speed: the highest speed; Other as the default.



# MAINTENANCE

Supplier's name or trade mark:

Supplier's address <sup>(b)</sup>:

Model identifier: MW7145W

General product parameters:

Parameter	Value		Parameter	Value	
Rated capacity <sup>(a)</sup> (kg)	7.0		Dimensions in cm	Height	85
				Width	60
				Depth	50
EE <sub>lw</sub> <sup>(a)</sup>	59.9		Energy efficiency class <sup>(a)</sup>	B	
Washing efficiency index <sup>(a)</sup>	1.04		Rinsing effectiveness (g/kg) <sup>(a)</sup>	5.0	
Energy consumption in kWh per cycle, based on the eco 40-60 programme. Actual energy consumption will depend on how the appliance is used.	0.516		Water consumption in litre per cycle, based on the eco 40-60 programme. Actual water consumption will depend on how the appliance is used and on the hardness of the water.	45	
Maximum temperature inside the treated textile <sup>(a)</sup> (°C)	Rated capacity	36	Remaining moisture content <sup>(a)</sup> (%)	Rated capacity	53
	Half	34		Half	53
	Quarter	21		Quarter	53
Spin speed <sup>(a)</sup> (rpm)	Rated capacity	1400	Spin-drying efficiency class <sup>(a)</sup>	B	
	Half	1400			
	Quarter	1400			
Programme duration <sup>(a)</sup> (h:min)	Rated capacity	3 : 28	Type	free-standing	
	Half	2 : 42			
	Quarter	2 : 42			
Airborne acoustical noise emissions in the spinning phase <sup>(a)</sup> (dB(A) re 1 pW)	76		Airborne acoustical noise emission class <sup>(a)</sup> (spinning phase)	B	
Off-mode (W)	0.50		Standby mode (W)	N/A	
Delay start (W) (if applicable)	4.00		Networked standby (W) (if applicable)	N/A	

Minimum duration of the guarantee offered by the supplier <sup>(b)</sup>:

This product has been designed to release silver ions during the washing cycle

NO

Additional information:

Weblink to the supplier's website, where the information in point 9 of Annex II to Commission Regulation (EU) 2019/2023 (1) (b) is found:

<sup>(a)</sup> for the eco 40-60 programme.

<sup>(b)</sup> changes to these items shall not be considered relevant for the purposes of paragraph 4 of Article 4 of Regulation (EU) 2017/1369.

<sup>(c)</sup> if the product database automatically generates the definitive content of this cell the supplier shall not enter these data.

# MAINTENANCE

Product fiche concerning to EN 60456:2016 With (EU)No.1061/2010.

Trade mark	
Model identifier	MW8145W
Rated capacity in kg of cotton laundry	8
Energy efficiency class on a scale from A+++ (most efficient) to D (least efficient )	A+++
Energy consumption 175kWh per year, based on 220 standard washing cycles for the standard cotton programmes at 60 °C and 40 °C at full and partial load, and the consumption of the low-power modes. Actual energy consumption will depend on how the appliance is used.	
Energy consumption of the standard 60°C cotton programme at full load	0.82kwh
Energy consumption of the standard 60°C cotton programme at partial load	0.75kwh
Energy consumption of the standard 40°C cotton programme at partial load	0.73kwh
Weighted power consumption of the off-mode	0.50W
Weighted power consumption of the left-on mode	1.00W
Water consumption 11000 litres per year, based on 220 standard washing cycles for the standard cotton programmes at 60 °C and 40 °C at full and partial load. Actual water consumption will depend on how the appliance is used.	
spin-drying efficiency class B on a scale from G (least efficient) to A (most efficient)	
maximum spin speed - RPM	1400
Remaining moisture content	53%
'Intensive 60°C programme' and the 'Intensive 40°C programme' are the standard washing programmes to which the information in the label and the fiche relates, that these programmes are suitable to clean normally soiled cotton laundry and that they are the most efficient programmes in terms of combined energy and water consumption.	
Programme time of the standard 60°C cotton programme at full load	280min
Programme time of the standard 60°C cotton programme at half load	270min
Programme time of the standard 40°C cotton programme at half load	270min
duration time of left-on mode	1min
Airborne acoustical noise emissions during washing phase	57dB
Airborne acoustical noise emissions during spinning phase	79dB
'built-in' washing machine	no

Energy test program: Intensive 60/40 °C; Speed: the highest speed; Other as the default.

# MAINTENANCE

Supplier's name or trade mark:

Supplier's address <sup>(b)</sup>:

Model identifier: MW8145W

General product parameters:

Parameter	Value		Parameter	Value	
Rated capacity <sup>(a)</sup> (kg)	8.0		Dimensions in cm	Height	85
				Width	59.5
				Depth	56.5
EE <sub>W</sub> <sup>(a)</sup>	60.0		Energy efficiency class <sup>(a)</sup>	B	
Washing efficiency index <sup>(a)</sup>	1.04		Rinsing effectiveness (g/kg) <sup>(a)</sup>	5.0	
Energy consumption in kWh per cycle, based on the eco 40-60 programme. Actual energy consumption will depend on how the appliance is used.	0.545		Water consumption in litre per cycle, based on the eco 40-60 programme. Actual water consumption will depend on how the appliance is used and on the hardness of the water.	48	
Maximum temperature inside the treated textile <sup>(a)</sup> (°C)	Rated capacity	34	Remaining moisture content <sup>(a)</sup> (%)	Rated capacity	53
	Half	29		Half	53
	Quarter	21		Quarter	53
Spin speed <sup>(a)</sup> (rpm)	Rated capacity	1400	Spin-drying efficiency class <sup>(a)</sup>	B	
	Half	1400			
	Quarter	1400			
Programme duration <sup>(a)</sup> (h:min)	Rated capacity	3 : 39	Type	free-standing	
	Half	2 : 48			
	Quarter	2 : 48			
Airborne acoustical noise emissions in the spinning phase <sup>(a)</sup> (dB(A) re 1 pW)	76		Airborne acoustical noise emission class <sup>(a)</sup> (spinning phase)	B	
Off-mode (W)	0.50		Standby mode (W)	N/A	
Delay start (W) (if applicable)	4.00		Networked standby (W) (if applicable)	N/A	

Minimum duration of the guarantee offered by the supplier <sup>(b)</sup>:

This product has been designed to release silver ions during the washing cycle

NO

Additional information:

Weblink to the supplier's website, where the information in point 9 of Annex II to Commission Regulation (EU) 2019/2023 (1) (b) is found:

<sup>(a)</sup> for the eco 40-60 programme.

<sup>(b)</sup> changes to these items shall not be considered relevant for the purposes of paragraph 4 of Article 4 of Regulation (EU) 2017/1369.

<sup>(c)</sup> if the product database automatically generates the definitive content of this cell the supplier shall not enter these data.

# MAINTENANCE

Product fiche concerning to EN 60456:2016 With (EU)No.1061/2010.

Trade mark	
Model identifier	MW9145W
Rated capacity in kg of cotton laundry	9
Energy efficiency class on a scale from A+++ (most efficient) to D (least efficient )	A+++
Energy consumption 174kWh per year, based on 220 standard washing cycles for the standard cotton programmes at 60 °C and 40 °C at full and partial load, and the consumption of the low-power modes. Actual energy consumption will depend on how the appliance is used.	
Energy consumption of the standard 60°C cotton programme at full load	0.85kwh
Energy consumption of the standard 60°C cotton programme at partial load	0.71kwh
Energy consumption of the standard 40°C cotton programme at partial load	0.70kwh
Weighted power consumption of the off-mode	0.50W
Weighted power consumption of the left-on mode	1.00W
Water consumption 11880 litres per year, based on 220 standard washing cycles for the standard cotton programmes at 60 °C and 40 °C at full and partial load. Actual water consumption will depend on how the appliance is used.	
spin-drying efficiency class B on a scale from G (least efficient) to A (most efficient)	
maximum spin speed - RPM	1400
Remaining moisture content	53%
'Intensive 60°C programme' and the 'Intensive 40°C programme' are the standard washing programmes to which the information in the label and the fiche relates, that these programmes are suitable to clean normally soiled cotton laundry and that they are the most efficient programmes in terms of combined energy and water consumption.	
Programme time of the standard 60°C cotton programme at full load	270min
Programme time of the standard 60°C cotton programme at half load	270min
Programme time of the standard 40°C cotton programme at half load	265min
duration time of left-on mode	1min
Airborne acoustical noise emissions during washing phase	57dB
Airborne acoustical noise emissions during spinning phase	79dB
'built-in' washing machine	no

Energy test program: Intensive 60/40 °C; Speed: the highest speed; Other as the default.

# MAINTENANCE

Supplier's name or trade mark:

Supplier's address <sup>(b)</sup>:

Model identifier: MW9145W

General product parameters:

Parameter	Value		Parameter	Value	
Rated capacity <sup>(a)</sup> (kg)	9.0		Dimensions in cm	Height	85
				Width	59.5
				Depth	56.5
EE <sub>lw</sub> <sup>(a)</sup>	59.9		Energy efficiency class <sup>(a)</sup>	B	
Washing efficiency index <sup>(a)</sup>	1.04		Rinsing effectiveness (g/kg) <sup>(a)</sup>	5.0	
Energy consumption in kWh per cycle, based on the eco 40-60 programme. Actual energy consumption will depend on how the appliance is used.	0.570		Water consumption in litre per cycle, based on the eco 40-60 programme. Actual water consumption will depend on how the appliance is used and on the hardness of the water.	49	
Maximum temperature inside the treated textile <sup>(a)</sup> (°C)	Rated capacity	34	Remaining moisture content <sup>(a)</sup> (%)	Rated capacity	53
	Half	34		Half	53
	Quarter	21		Quarter	53
Spin speed <sup>(a)</sup> (rpm)	Rated capacity	1400	Spin-drying efficiency class <sup>(a)</sup>	B	
	Half	1400			
	Quarter	1400			
Programme duration <sup>(a)</sup> (h:min)	Rated capacity	3 : 49	Type	free-standing	
	Half	2 : 54			
	Quarter	2 : 54			
Airborne acoustical noise emissions in the spinning phase <sup>(a)</sup> (dB(A) re 1 pW)	76		Airborne acoustical noise emission class <sup>(a)</sup> (spinning phase)	B	
Off-mode (W)	0.50		Standby mode (W)	N/A	
Delay start (W) (if applicable)	4.00		Networked standby (W) (if applicable)	N/A	

Minimum duration of the guarantee offered by the supplier <sup>(b)</sup>:

This product has been designed to release silver ions during the washing cycle

NO

Additional information:

Weblink to the supplier's website, where the information in point 9 of Annex II to Commission Regulation (EU) 2019/2023 (1) (b) is found:

<sup>(a)</sup> for the eco 40-60 programme.

<sup>(b)</sup> changes to these items shall not be considered relevant for the purposes of paragraph 4 of Article 4 of Regulation (EU) 2017/1369.

<sup>(c)</sup> if the product database automatically generates the definitive content of this cell the supplier shall not enter these data.

# MAINTENANCES

---

## Note!

- Programme setting for testing in accordance with applicable standard En60456.
- When using the test programmes, wash the specified load using the maximum spin speed.
- The actual parameters will depend on how the appliance is used, and maybe different with the parameters in above mentioned table.
- The household washing machine is equipped with power management system. The duration of the left-on mode time is less than 10 minute.
- The noise emissions during washing/spinning for the standard washing cycle at full load.

# Here For You

## After-sales assistance

If you continue to experience problems with your Washing Machine, please call the Montpellier customer service helpline on: **01759 487839**

Please have all your product details available, including the model number, serial number, date of purchase, and your retailer's details before registering a fault.

The service call cannot progress without this information.

## Your 2 year Manufacturer's guarantee

THIS DOES NOT AFFECT YOUR STATUTORY RIGHTS.

Your new Montpellier appliance carries a free guarantee which protects you against the cost of repairs during the first 24 months from date of purchase provided that:

Any claim is accompanied by evidence of the model reference, model serial number and proof of purchase, such as a Sales Receipt, showing that the appliance was purchased within the 24 months prior to the date of claim.

## What is not covered under the Guarantee

- Any appliance not correctly installed and operated in accordance with the manufacturer's instructions.
- Any appliance that is used for anything other than domestic purposes.  
Any defect caused by accident, misuse, unauthorised modification or inexpert repair.
- Cost of Call-out where a fault cannot be found with the appliance.  
Cost of Call-out for work covering routine maintenance, such as, but not exclusively, cleaning of filters or defrosting.
- Cost of Call-out for work required to correct the alignment of doors following door reversal procedures carried out by you.  
Use of the appliance by anyone other than the Householder.  
Use in any commercial environment.
- Consumable items, such as, but not exclusively, fuses in plugs, bulbs and breakable items which require routine replacement.  
Repair costs incurred that have not been authorised by Montpellier service and/or carried out by a non-approved Montpellier engineer.
- Montpellier Appliances do not accept claims for consequential loss, rusting, corroding, delivery damage or scratches.

## YOUR GUARANTEE IS VALID ONLY IN THE UK.

To register your appliance simply complete the card in your appliance pack and return it with a stamp affixed or alternatively you can register online at **[www.montpellier-appliances.com/support](http://www.montpellier-appliances.com/support)**

## SERVICE HELP-LINE

Should your appliance develop a fault, please call the Montpellier customer service helpline on: **01759 487839**

Please remember to have all your product details available, including the model number, serial number, date of purchase and your retailer's details before registering a fault.

**Montpellier Domestic Appliances Ltd.**

Unit 1, Tewkesbury Retail Park, Northway Lane,  
Tewkesbury, Gloucestershire GL20 8JU

[www.montpellier-appliances.com](http://www.montpellier-appliances.com)



The symbol on the product or on its packaging indicates that this product may not be treated as household waste. Instead it shall be handed over to the applicable collection point for the recycling of electrical and electronic equipment. By ensuring this product is disposed of correctly, you will help prevent potential negative consequences for the environment and human health, which could otherwise be caused by inappropriate waste handling of this product. For more detailed information about recycling of this product, please contact your local city office, your household waste disposal service or the shop where you purchased the product.